



NEW SASH HEIGHTS 210-215-220cm

# AVAILABLE

ON THESE DESIGNS



ADO100



ADO330



ADO410



ADO500



ADO2000



ADO2100



ADO1134



ADO1122-R



ADO1132

# DEODORA SERIES

**NEW**



ADO100



ADO100



ADO100



ADO100



ADO100



ADO100



ADO100



ADO101



ADO103



ADO106



ADO106YK

 WATER RESISTANT	 RESISTANT TO IMPACTS	 ANTI- BACTERIAL	 RESISTANT TO MOISTURE	 PAINT AND MAINTENANCE ARE NOT REQUIRED	 B1 FIREPROOF										
--	--	---	---	---	--	---	---	--	---	---	---	---	---	---	---

# DEODORA SERIES



ADO300



ADO300



ADO300



ADO300



ADO301



ADO301



ADO301



ADO301



ADO305



ADO305



ADO305



ADO305

-   
**WATER RESISTANT**
-   
**RESISTANT TO IMPACTS**
-   
**ANTI-BACTERIAL**
-   
**RESISTANT TO MOISTURE**
-   
**PAINT AND MAINTENANCE ARE NOT REQUIRED**
-   
**B1 FIREPROOF**





# DEODORA SERIES



ADO330



ADO330



ADO330



ADO330



ADO331



ADO331



ADO331



ADO331



ADO350



ADO350



ADO351



ADO351



WATER RESISTANT



RESISTANT TO IMPACTS



ANTI-BACTERIAL



RESISTANT TO MOISTURE



PAINT AND MAINTENANCE ARE NOT REQUIRED



B1 FIREPROOF



WHITE TEAK

WHITE MAPLE

WALNUT

TEAK

DARK WALNUT

# DEODORA SERIES



ADO300



ADO300



ADO300



ADO300



ADO301



ADO301



ADO301



ADO301



ADO305



ADO305



ADO305



ADO305

-   
**WATER RESISTANT**
-   
**RESISTANT TO IMPACTS**
-   
**ANTI-BACTERIAL**
-   
**RESISTANT TO MOISTURE**
-   
**PAINT AND MAINTENANCE ARE NOT REQUIRED**
-   
**B1 FIREPROOF**



# DEODORA SERIES



ADO500



ADO500



ADO500



ADO500



ADO700



ADO700



ADO700



ADO700



ADO800



ADO800



ADO800



ADO800

-   
 WATER RESISTANT
-   
 RESISTANT TO IMPACTS
-   
 ANTI-BACTERIAL
-   
 RESISTANT TO MOISTURE
-   
 PAINT AND MAINTENANCE ARE NOT REQUIRED
-   
 B1 FIREPROOF





# DEODORA SERIES



**ADO2000  
ARGENTO MİX**



**ADO2000  
WHITE TEAK MİX**



**ADO2000  
TEAK MİX**



**ADO2100  
MILANO CEVİZ MİX**



**ADO1134**



**ADO1134**



**ADO1132**



**ADO1132**



**ADO1122-R**



**ADO1122-R**



**ADO1103-R**



**ADO1103-R**

-   
WATER  
RESISTANT
-   
RESISTANT  
TO IMPACTS
-   
ANTI-  
BACTERIAL
-   
RESISTANT  
TO MOISTURE
-   
PAINT AND  
MAINTENANCE  
ARE NOT REQUIRED
-   
B1  
FIREPROOF



# FAGUS SERIES



ADO3000



ADO3000



ADO3000



ADO3000



ADO3000



ADO3000



ADO3000



ADO3000



ADO3003



ADO3003



ADO3006



ADO3006

-  WATER RESISTANT
-  RESISTANT TO IMPACTS
-  PAINT AND MAINTENANCE ARE NOT REQUIRED





# FAGUS SERIES



ADO3122-R



ADO3122-R



ADO3122-R



ADO3122-R



ADO3122-R



ADO3122-R



ADO3122-R



ADO3201



ADO3202



ADO3203



ADO3210



WATER RESISTANT



RESISTANT TO IMPACTS



PAINT AND MAINTENANCE ARE NOT REQUIRED



# FAGUS SERIES



ADO3201-3



ADO3202-3



ADO3203-3



ADO3210-3



ADO3220



ADO3223



ADO3230



ADO3232



ADO3220-3



ADO3223-3



ADO3230-3



ADO3232-3

 WATER RESISTANT  
 RESISTANT TO IMPACTS  
 PAINT AND MAINTENANCE ARE NOT REQUIRED



# FAGUS SERIES



ADO3380



ADO3386



ADO3268



ADO3286



ADO3310



ADO3330



ADO3310-3



ADO3330-3



ADO3430-33



ADO3430-34



ADO3430-84



ADO3430-85

 WATER RESISTANT  
 RESISTANT TO IMPACTS  
 PAINT AND MAINTENANCE ARE NOT REQUIRED







ADO4000



ADO4000



ADO4000



ADO4000

# CEDRUS SERIES



ADO7010



ADO7010



ADO7010



ADO7011



ADO7011



ADO7011



ADO7300



ADO7300



ADO7300

 WATER RESISTANT  
 RESISTANT TO IMPACTS  
 PAINT AND MAINTENANCE ARE NOT REQUIRED





**ADO7060**



**ADO7060**



**ADO7061**



**ADO7400**



**ADO7400**



**ADO7403**



**ADO7500**



**ADO7500**



**ADO7500**

 **WATER RESISTANT**  
 **RESISTANT TO IMPACTS**  
 **PAINT AND MAINTENANCE ARE NOT REQUIRED**







ADO7020



ADO7020



ADO7020



ADO7023



ADO7024



ADO7024

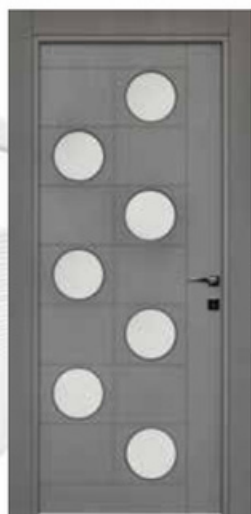

ADO7027



ADO7027



ADO7027

 WATER RESISTANT  
 RESISTANT TO IMPACTS  
 PAINT AND MAINTENANCE ARE NOT REQUIRED





**ADO7040**



**ADO7040**



**ADO7040**



**ADO7044**



**ADO7044**



**ADO7044**



**ADO7050**



**ADO7050**



**ADO7050**





ADO7059



ADO7059



ADO7059



ADO7750



ADO7750

Note: Gold Walnut color is just available for 7750 model.

-   
 WATER RESISTANT
-   
 RESISTANT TO IMPACTS
-   
 PAINT AND MAINTENANCE ARE NOT REQUIRED





# Fire Rated Doors



**CERTIFIED  
TEST  
PROVEN**

 **30**  
mins.

 **60**  
mins.

 **90**  
mins.

 **120**  
mins.

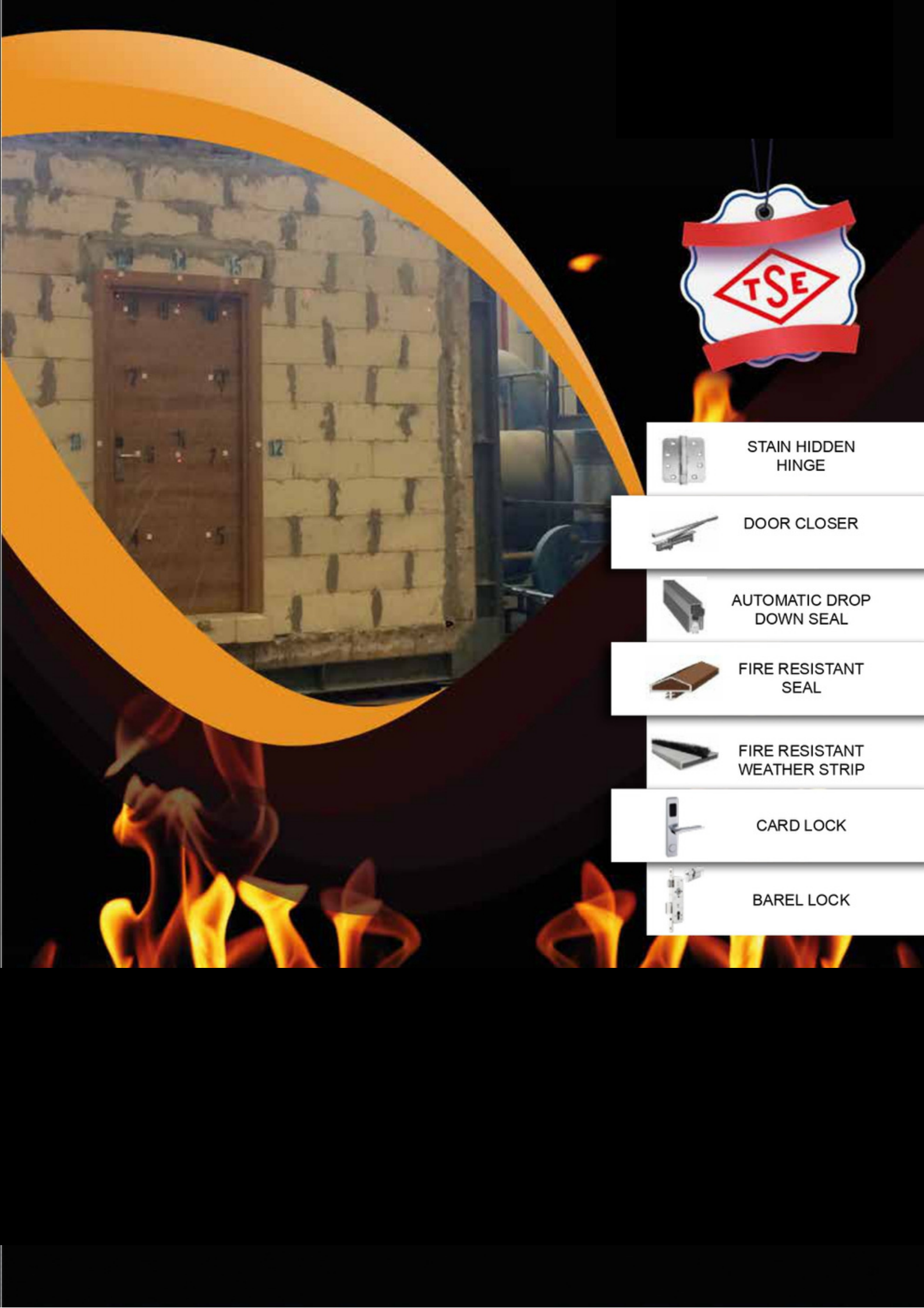

STAIN HIDDEN  
HINGE



DOOR CLOSER



AUTOMATIC DROP  
DOWN SEAL



FIRE RESISTANT  
SEAL



FIRE RESISTANT  
WEATHER STRIP



CARD LOCK



BAREL LOCK



# TECHNICAL SPECIFICATIONS

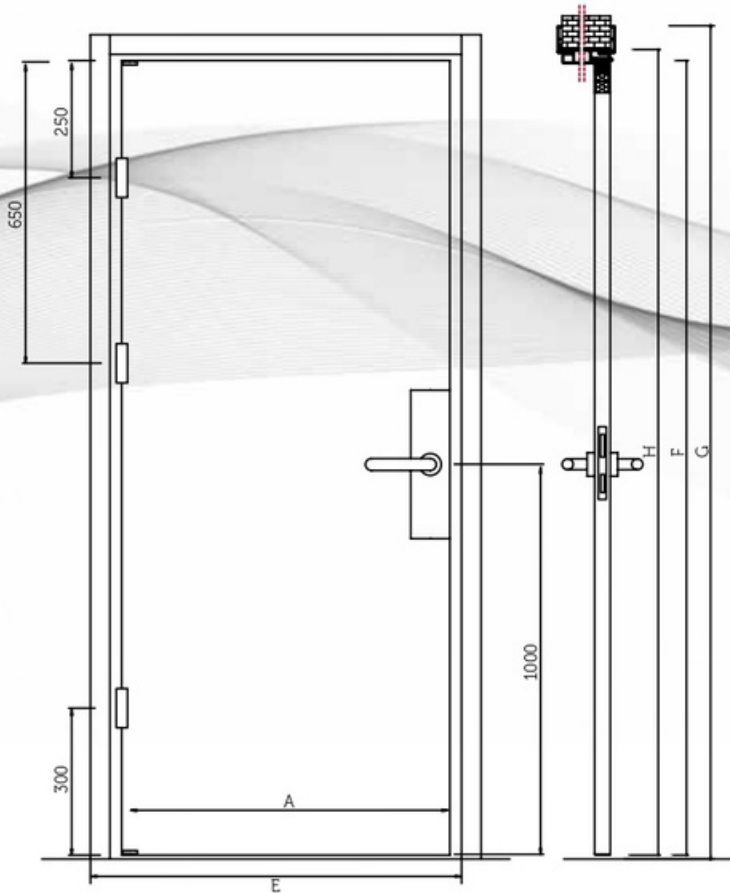

Sash Widths (mm): 650 - 700 - 750 - 800 - 850 - 900

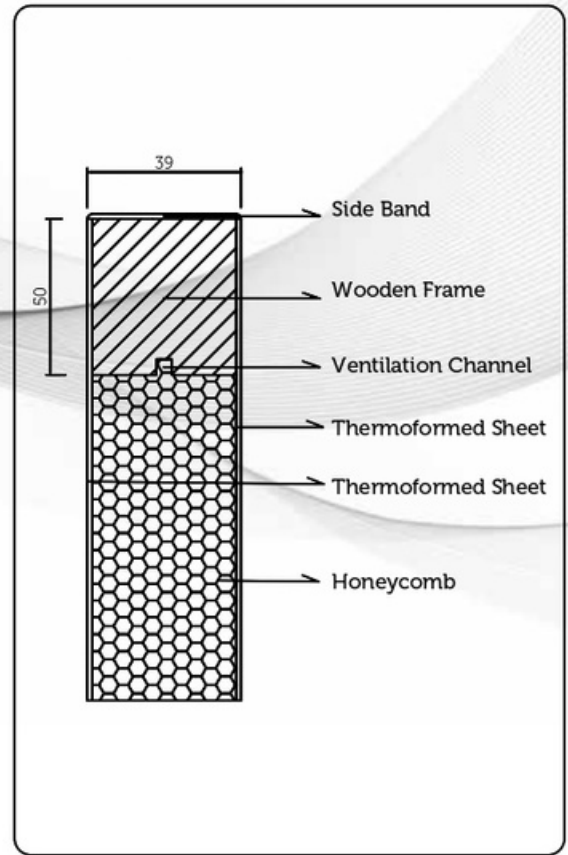

Deodara Sash Detail

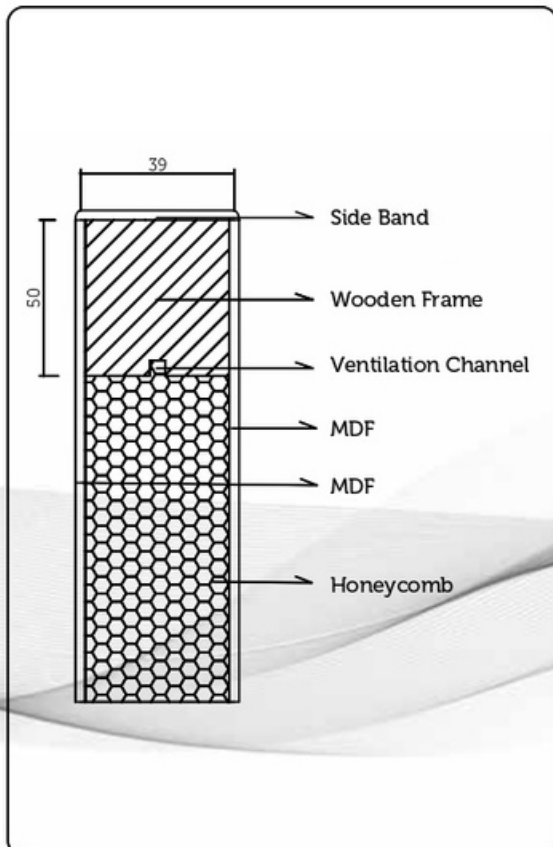

Fagus and Cedrus Sash Detail

## SASH LENGTH MEASUREMENT

SASH MEASUREMENT	FRAME OUTER MEASUREMENT	70mm CORNICE OUTER MEASUREMENT	100mm CORNICE OUTER MEASUREMENT
F	H	G	G
2030	2073	2133	2163

## SASH WIDTH MEASUREMENT

SASH MEASUREMENT	FRAME OUTER MEASUREMENT	70mm CORNICE OUTER MEASUREMENT	100mm CORNICE OUTER MEASUREMENT
A	C	E	E
650	705	825	855
700	755	875	905
750	805	925	955
800	855	975	1005
850	905	1025	1055
900	955	1075	1105

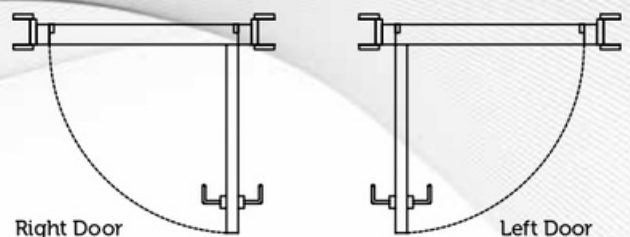

Right Door

Left Door

Adokapi may change these technical specifications.



# TECHNICAL SPECIFICATIONS

FRAME: 70 - 100 - 120 - 140 - 160 - 180 - 200 - 220

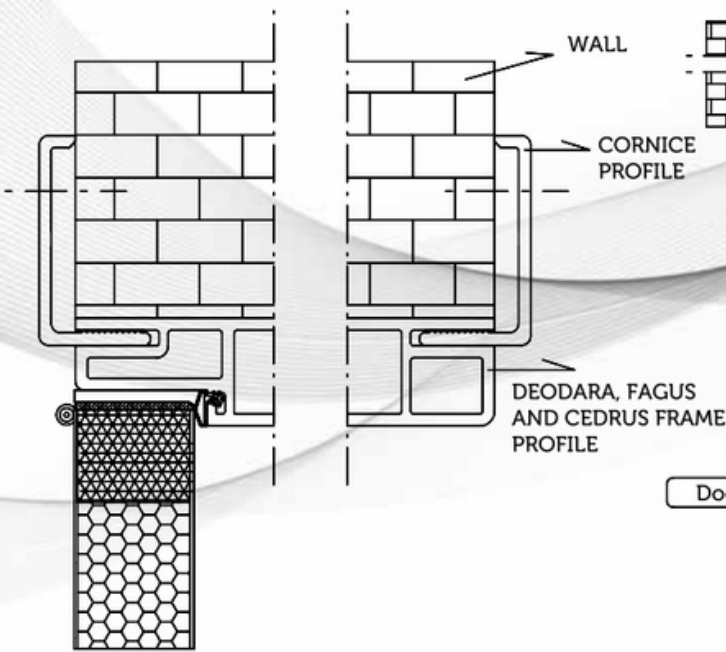

Door frame connection detail up

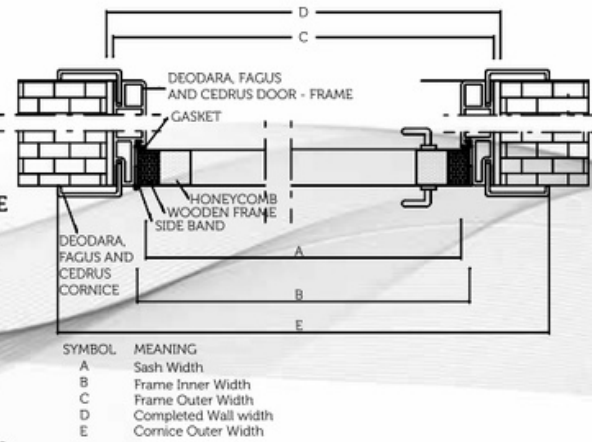

SYMBOL	MEANING
A	Sash Width
B	Frame Inner Width
C	Frame Outer Width
D	Completed Wall width
E	Cornice Outer Width

Door Frame Connect Systems Detail

## FRAME WIDTH MEASUREMENT

FRAME WIDTH (mm)	WALL THICKNESS (min.)	WALL THICKNESS (max.)
70	70	99
100	100	119
120	120	139
140	140	159
160	160	179
180	180	199
200	200	219
220	220	239



Door Cornice 100

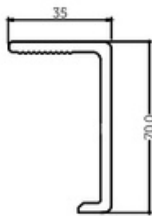

Door Cornice 70

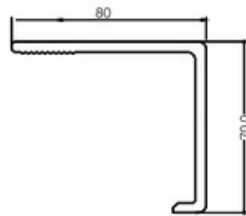

Door Cornice 70x80

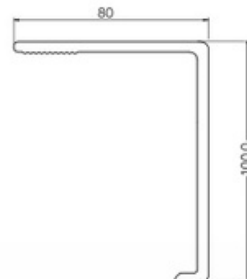

Door Cornice 100x80



Oval Door Cornice 70



Frame extension cornice 70x150

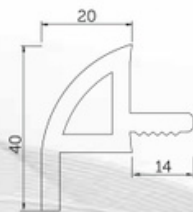

Frame Channel Cover Cornice

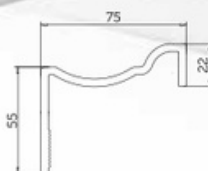

Decorative Top Cornice

## Fagus and cedrus sash specifications

- Wooden frame
- 3 pieces of 26x50 mm wooden frame are used on the bottom.
- 0,2 mm foil coating over 6 mm MDF.
- Inner core is Kraft core and/or fire resistant section.

## Deodora sash specifications

- Wooden frame.
- 3 pieces of 26x50 mm wooden frame are used on the bottom.
- 0,2 mm foil coating over 2 mm PVC.

## Fagus Deodora and Cedrus frame – cornice specifications

- Composite material.
- Not affected by water and moisture.

In Fagus and Cedrus ranges, water and moisture resistance are valid only for frames and cornice. Adokapi products are interior doors. If they are used outdoors, factory warranty is not provided.

# DOOR FRAME & CORNICE APPLICATION

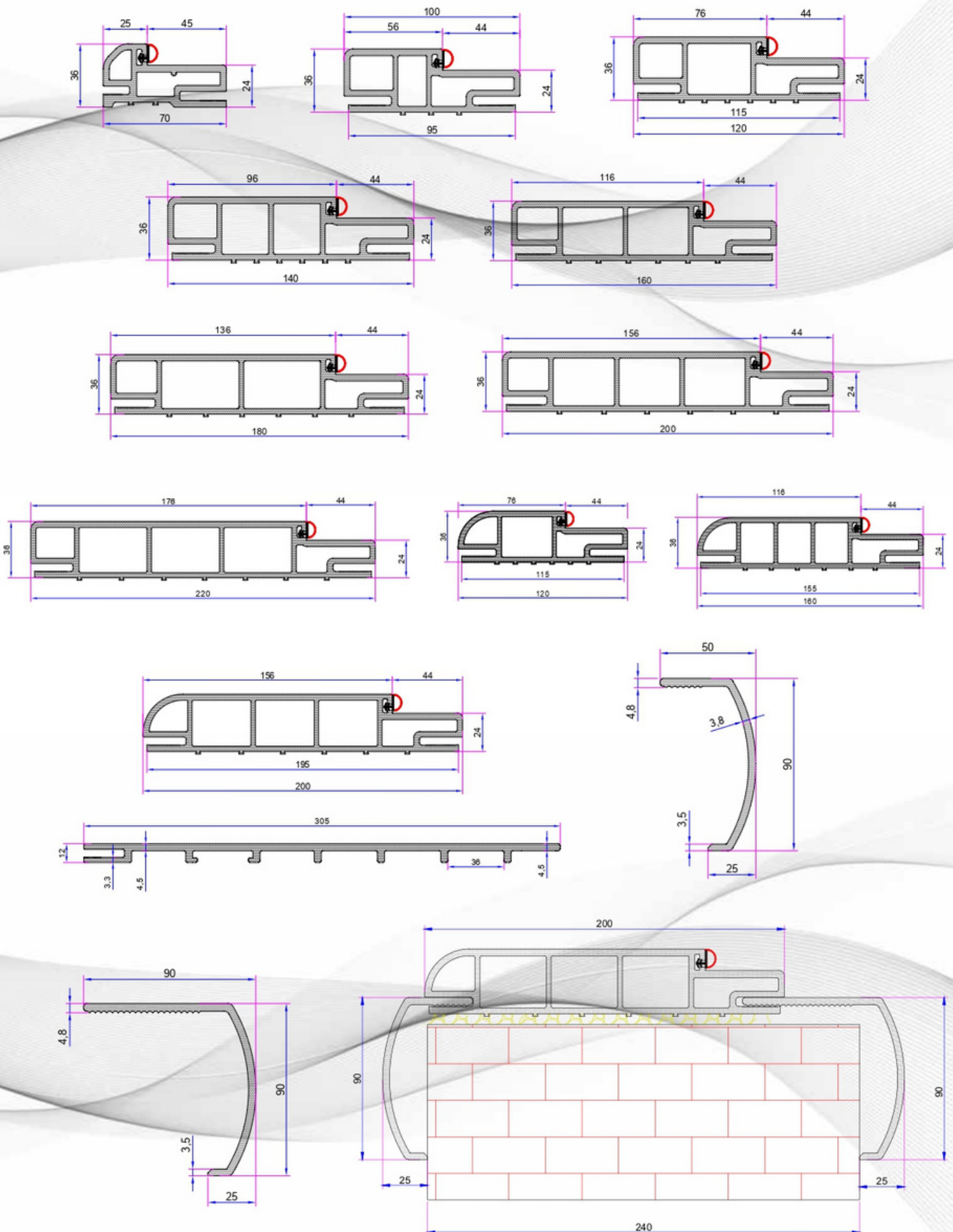

# DOOR ACCESSORIES



Cylinder Type Lock



Room Type Lock



Bravo Handle



Bow Handle



Hinge



WC Type Lock



# DOOR ASSEMBLY

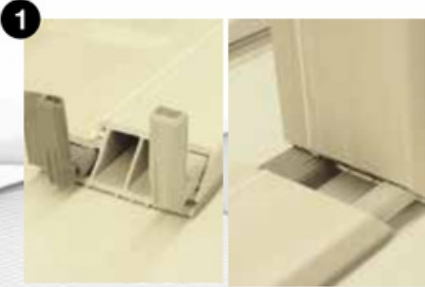

1 Frame edge jointing apparatuses are fitted as shown in the figure and their edges are jointed.



2 The frame is placed in the wall gap in the middle. Squeezing pins are placed in the upper and side gaps and fixed by adjusting with the measurement gauge.



3 For Deodara range doors, ADOKAPI label is screwed on the lower and upper edge of the leaf as shown in the figure.



4 Hinges are screwed to the leaf with the upper hinge center 250 mm and lower hinge center 300 mm.



5 Upper hinge center is screwed to the frame as 254 mm from above.



6 Adjust the internal measurement between sash and frame as 3.5 mm by using an adjuster. Frame - Sash balance should be checked again.



7 Apply polyurethane foam in the gap between the frame and wall. After drying, remove the foam residues.



8 Lock is screwed to the drilled area in the frame.



9 Lock and handle suitable for the leaf are fitted by screwing them.



10 Double-side adjusted cornice are cut according to the measurement and fitted by using a plastic hammer.

## STACKING CONDITIONS

- 1- Pallet packaging of the door components that will be kept in the stocks should not be opened unless needed.
- 2- Stacking floor should be flat and levelled.
- 3- Stacks should be supported in the horizontal position with minimum 3 wedges. They should not be stacked vertically even in the construction sites.
- 4- Ensure that the wedges to be used for stacking have equal sizes and are not twisted.
- 5- Wedges should be placed in between the stacks to be placed on top of each other at the same level of the wedges on the floor.
- 6- Base pallet should be placed on top of the door leaves that will not be removed for a long time.
- 7- Products should not be stacked in the warehouses with insufficient ventilation and air-conditioning (ensure 22-24 degrees and 8-12% balance moisture).
- 8- Make sure that the products are not exposed to direct sunlight, wind and water.
- 9- Protect the products against any damages that might occur due to the use of forklift for loading and unloading.

## OUR ASSEMBLY MATERIALS

Sashe – Cornice- Hinge – Screws- Lock